

100
0 10
Millimetres

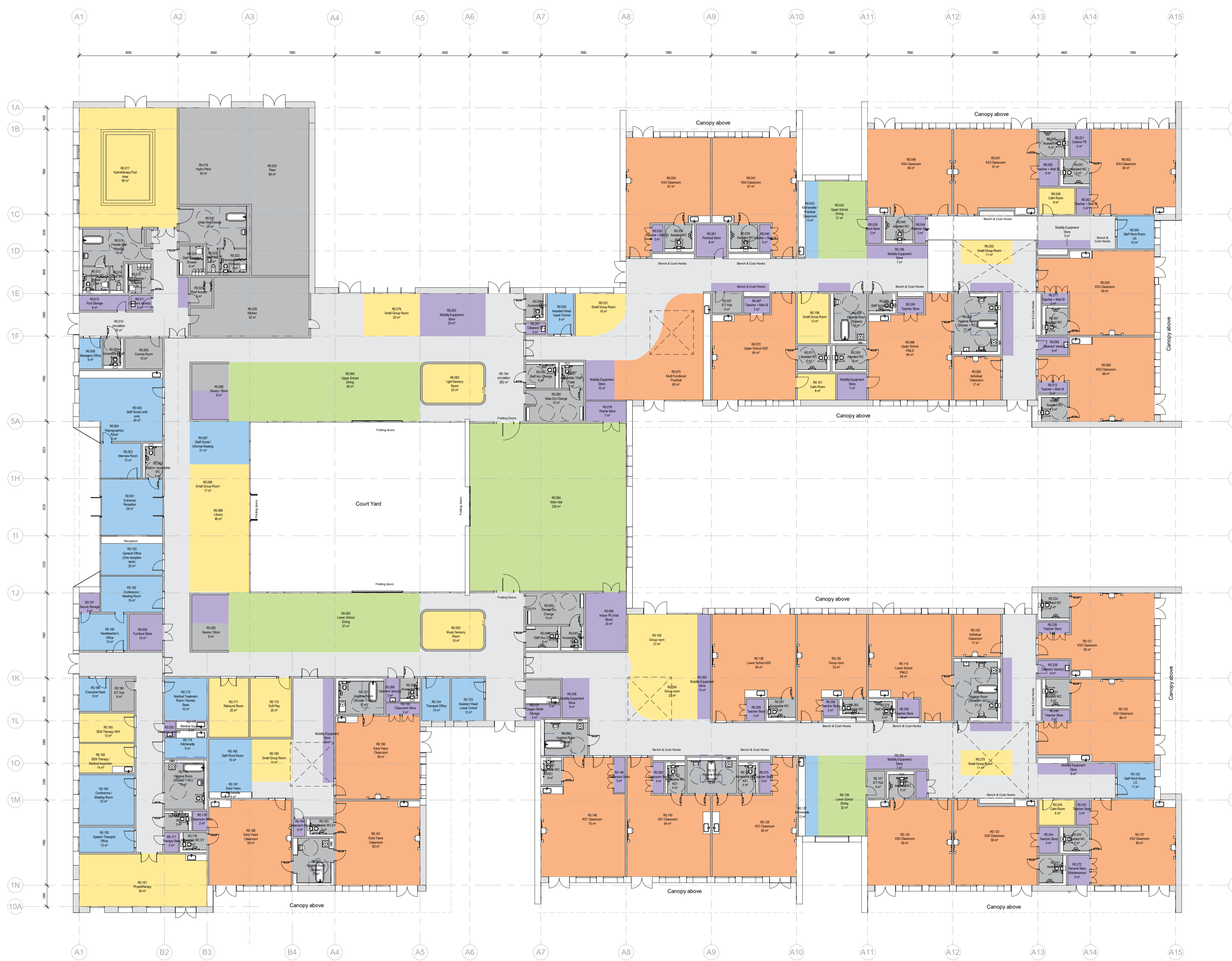

Room Schedule MS3			Room Schedule MS3		
Department	Name	Area	Department	Name	Area
CIRCULATION	Circulation	914 m ²	STAFF	Conference / Meeting Room	42 m ²
CIRCULATION: 34			STAFF	Early Years Kitchenette	6 m ²
HALL	Autism Dining	0 m ²	STAFF	Entrance/ Reception	29 m ²
HALL	Lower School Dining	129 m ²	STAFF	Executive Head	8 m ²
HALL	Main Hall	220 m ²	STAFF	General Office (One reception desk)	20 m ²
HALL: 7	Upper School Dining	126 m ²	STAFF	Headteacher's Office	15 m ²
LEARNING RESOURCE		475 m ²	STAFF	Interview Room	12 m ²
LEARNING RESOURCE	Calm Room	15 m ²	STAFF	Kitchenette	22 m ²
LEARNING RESOURCE	Hydrotherapy Pool Area	98 m ²	STAFF	Kitchenette / Practical Classroom	13 m ²
LEARNING RESOURCE	Library	45 m ²	STAFF	Managers Office	6 m ²
LEARNING RESOURCE	Light Sensory Room	20 m ²	STAFF	Medical Treatment Room / Nurses Base	15 m ²
LEARNING RESOURCE	Music Sensory Room	19 m ²	STAFF	Nurses Base	6 m ²
LEARNING RESOURCE	Physiotherapy	56 m ²	STAFF	Reprographics Room	6 m ²
LEARNING RESOURCE	Rebound Room	20 m ²	STAFF	Speech Therapist Office	12 m ²
LEARNING RESOURCE	SEN Therapy / Medical Inspection	14 m ²	STAFF	Staff Social (with sink)	40 m ²
LEARNING RESOURCE	SEN Therapy Y/Hi	13 m ²	STAFF	Staff Social / Informal Meeting	21 m ²
LEARNING RESOURCE	Small Group Room	103 m ²	STAFF	Staff Work Room	15 m ²
LEARNING RESOURCE	Soft Play	20 m ²	STAFF	Staff Work Room LS	11 m ²
LEARNING RESOURCE: 34		425 m ²	STAFF	Staff Work Room US	10 m ²
LIBRARY			STAFF: 35	Therapist Office	334 m ²
LIBRARY	Calm Room	8 m ²	STORAGE		
LIBRARY	Group room	59 m ²	STORAGE	Calm Room	0 m ²
LIBRARY	KS2 (Severe Autism)	0 m ²	STORAGE	Central Store	0 m ²
LIBRARY	Music Sensory Room	0 m ²	STORAGE	Classroom Store	13 m ²
LIBRARY: 14		68 m ²	STORAGE	Cleaners' St	2 m ²
NON-NET	Accessible / Staff Toilet	12 m ²	STORAGE	Cleaners' store(s)	16 m ²
NON-NET	Accessible WC	11 m ²	STORAGE	coals	0 m ²
NON-NET	Accessible WC + Shower	12 m ²	STORAGE	Drama Store	7 m ²
NON-NET	Accessible WC Autism	0 m ²	STORAGE	Food Store	3 m ²
NON-NET	Accessible WC EY	6 m ²	STORAGE	Furniture Store	10 m ²
NON-NET	Accessible WC KS1	15 m ²	STORAGE	General Store (Maintenance)	5 m ²
NON-NET	Assisted WC	77 m ²	STORAGE	Indoor PE (Hall Store)	4 m ²
NON-NET	Chem. Store	2 m ²	STORAGE	Medical Supplies	2 m ²
NON-NET	Comms Room	10 m ²	STORAGE	Mobility Equipment Store	125 m ²
NON-NET	Female Dry Change	15 m ²	STORAGE	Outdoor PE	5 m ²
NON-NET	Female Wet Change	19 m ²	STORAGE	Oxygen Bottle Storage	4 m ²
NON-NET	Hydro Plant	50 m ²	STORAGE	Pool Storage	6 m ²
NON-NET	Hygiene Room (Shower + WC)	69 m ²	STORAGE	Practical Store	8 m ²
NON-NET	Hygiene Room (Shower)	52 m ²	STORAGE	Practical Classroom Store	0 m ²
NON-NET	ICT Hub	15 m ²	STORAGE	Secure Storage	3 m ²
NON-NET	Kitchen	52 m ²	STORAGE	Severy / Store	18 m ²
NON-NET	KS3 Classroom	0 m ²	STORAGE	Teacher + Mob St	21 m ²
NON-NET	Laundry	7 m ²	STORAGE	Teacher Store	32 m ²
NON-NET	Male Dry Change	15 m ²	STORAGE	Therapy Store	2 m ²
NON-NET	Male Wet Change	24 m ²	STORAGE: 137		304 m ²
NON-NET	Plant	88 m ²	TEACHING ACCOMMODATION		
NON-NET	Roof Access	5 m ²	TEACHING ACCOMMODATION	Early Years Classroom	177 m ²
NON-NET	Sensory Control Area	1 m ²	TEACHING ACCOMMODATION	Group room	53 m ²
NON-NET	Severy / Store	17 m ²	TEACHING ACCOMMODATION	Individual Classroom	34 m ²
NON-NET	Staff Acc Change	12 m ²	TEACHING ACCOMMODATION	KS1 Classroom	204 m ²
NON-NET	Staff Accessible WC	11 m ²	TEACHING ACCOMMODATION	KS2 (Severe Autism)	0 m ²
NON-NET	Staff Change / Shower	12 m ²	TEACHING ACCOMMODATION	KS2 Classroom	310 m ²
NON-NET	Staff WC	5 m ²	TEACHING ACCOMMODATION	KS3 (Severe Autism)	0 m ²
NON-NET	Teacher Store	0 m ²	TEACHING ACCOMMODATION	KS3 Classroom	253 m ²
NON-NET	Visitors / accessible WC	5 m ²	TEACHING ACCOMMODATION	KS4 (Severe Autism)	0 m ²
NON-NET: 90		616 m ²	TEACHING ACCOMMODATION	KS4 Classroom	194 m ²
STAFF	Assistant Head Lower School	12 m ²	TEACHING ACCOMMODATION	Lower School ASD	65 m ²
STAFF	Assistant Head Upper School	9 m ²	TEACHING ACCOMMODATION	Lower School PMLD	64 m ²
STAFF	Autism Head	0 m ²	TEACHING ACCOMMODATION: 41		1542 m ²
STAFF	Autism Kitchenette	0 m ²	TEACHING ACCOMMODATION	Multi Functional Practical	60 m ²
STAFF	Autism Staff Work Rm	0 m ²	TEACHING ACCOMMODATION	Upper School ASD	64 m ²
			TEACHING ACCOMMODATION	Upper School PMLD	64 m ²
			WCs: 1		0 m ²
			WCs	Staff WC	0 m ²
			WCs: 1		0 m ²
			Grand total: 393		4677 m ²

By Department Legend

- CIRCULATION
- HALL
- LEARNING RESOURCE
- LIBRARY
- NON-NET
- STAFF
- STORAGE
- TEACHING ACCOMMODATION



1 Level 00 Floor Plan
011010 SCALE 1:200

Note:
MS2 Architectural drawings are to be read in conjunction with MS2 Architectural Report and MS2 Outline Specification as well as all other relevant discipline reports and drawings, including Atkins Structures, Civils and Landscape, CPW MEP, MLM Fire Strategy Report and AJA Acoustic Report

Rev.	Model Name

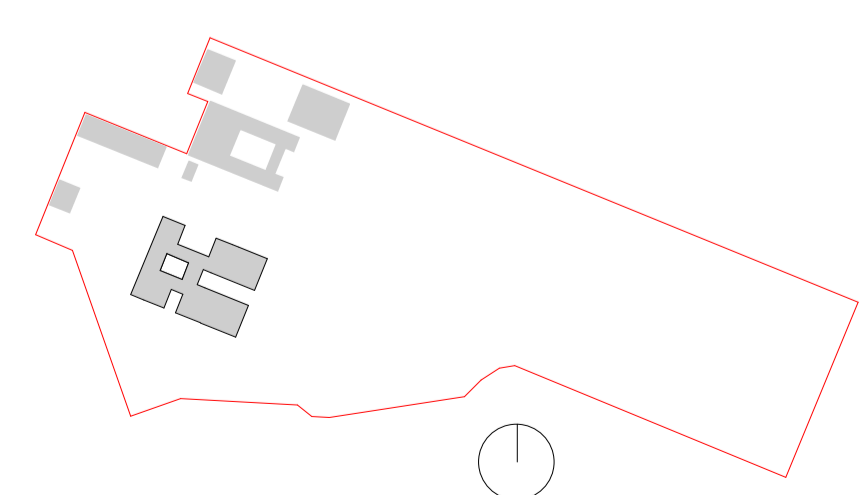

SAFETY, HEALTH AND ENVIRONMENTAL INFORMATION

In addition to the hazards/risks normally associated with the types of work detailed on this drawing, note the following:

- CONSTRUCTION
- MAINTENANCE/CLEANING
- DECOMMISSIONING/DEMOLITION

It is assumed that all works will be carried out by a competent contractor working, where appropriate, to an approved method statement

Rev.	Date	Description	By	Chk'd	App'd

Drawing Subtitle: **FOR APPROVAL** Status: **S4**

SNC-LAVALIN
ATKINS
Member of the SNC-Lavalin Group

MORGAN SINDALL

Client: Nova North
11 Bressenden Place
Westminster
London SW1E 5BY
Tel: 020 7121 2000
www.atkinsglobal.com
© SNC-Lavalin (2019)

Project Title: **Prestley Wood Academy**

Drawing Title: **Proposed Ground Floor Plan**

Scale	Designed	Drawn	Checked	Authorised
1:200	SV	SL	KD	RC

Original Size	Date	Date	Date	Date
A1	26/02/2021	26/02/2021	26/02/2021	26/02/2021

Drawing Number: **5201229-ATK-05-00-DR-AR-011010**

Atkins Project Number: 5201229